



For more Hi-Fi manuals and set-up information  
please visit [www.hifiengine.com](http://www.hifiengine.com)

# SPEAKER SYSTEM NS-45E

## SERVICE MANUAL

NS-45E

### ■ DIMENSIONS

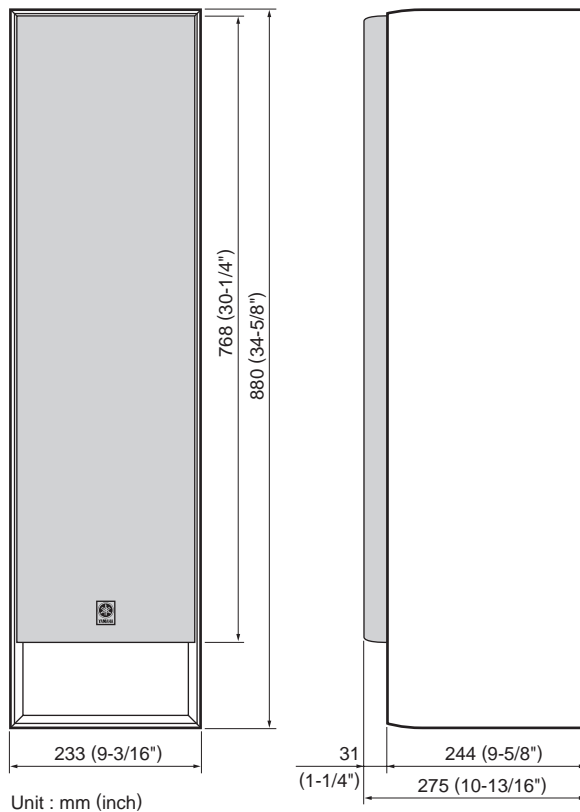

### ■ SPECIFICATIONS

**Type** ..... 2-way 3-speaker bass reflex speaker system

**Speaker Unit**

**Woofer** ..... 16 cm (6.5") cone x 2

**Tweeter** ..... 3 cm (1") dome

**Input Terminal** ..... Screw-type

**Impedance** ..... 6 ohms

**Frequency Response** ..... 38 Hz – 30 kHz

**Nominal Input Power** ..... 80 W

### ■ NETWORK CIRCUIT DIAGRAM

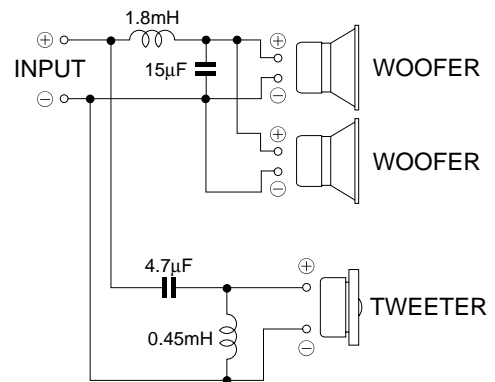

### ■ WIRING DIAGRAM

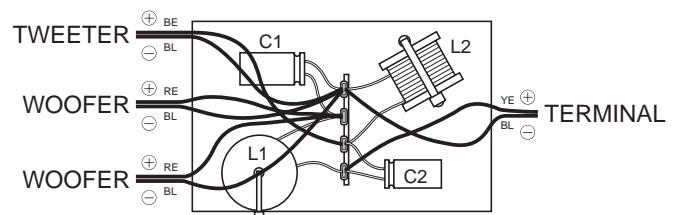

**Maximum Input Power** ..... 240 W

**Sensitivity** ..... 90 dB/2.83 V/m

**Crossover Frequency** ..... 3 kHz

**Dimensions (W x H x D)** ..... 233 x 880 x 275 mm  
 (9-3/16" x 34-5/8" x 10-13/16")

**Weight** ..... 11.6 kg (25 lbs. 8 oz.) /1 piece

**Accessories** ..... Speaker cord (4m) x 2, Stand x 8,  
 Screw x 16, Leg x 8



このサービスマニュアルは、エコマーク認定の再生紙を使用しています。  
 This Service Manual uses recycled paper.

\* Specifications are subject change without notice due to product improvements.

NS-45E

EXPLODED VIEW

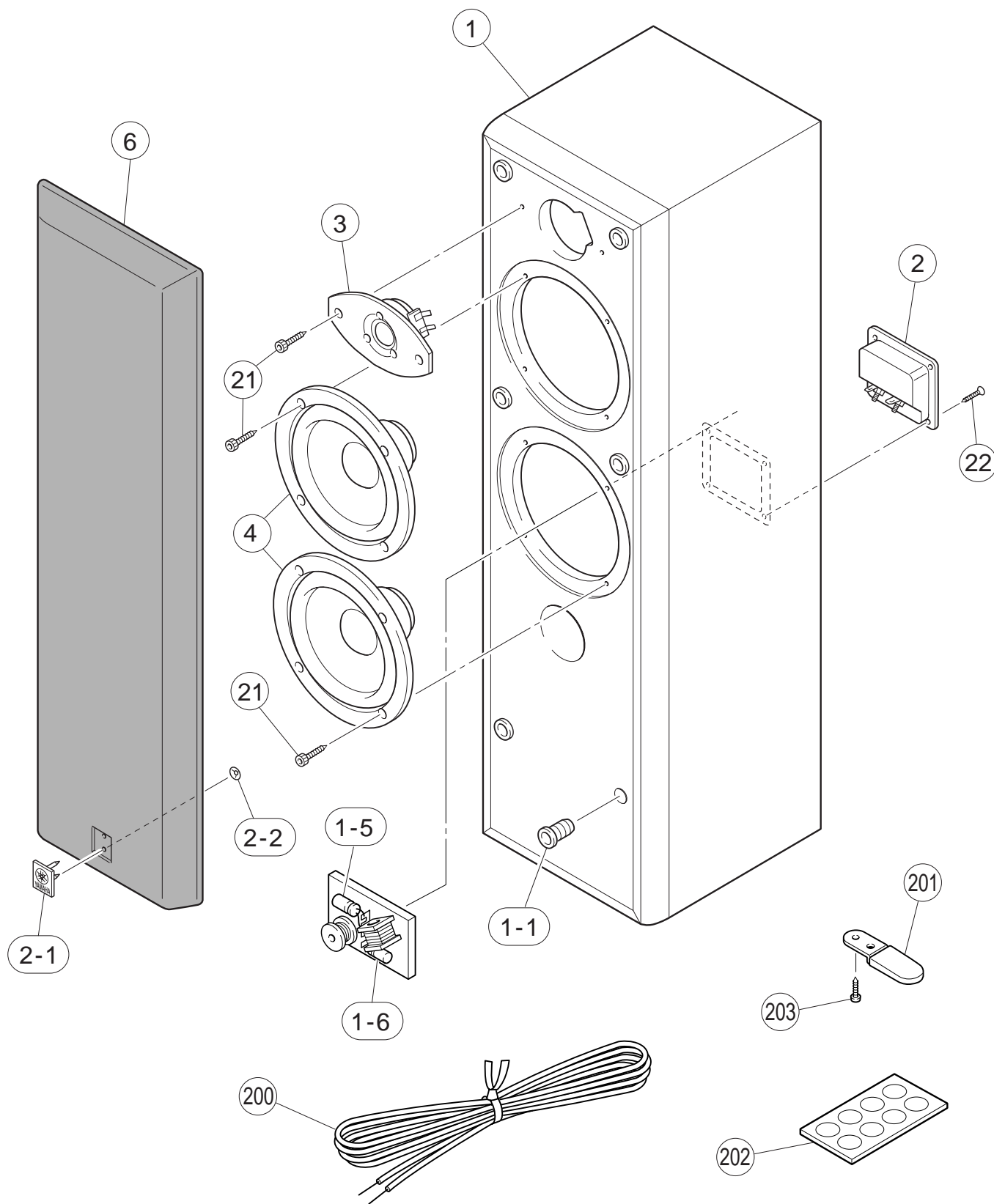

## ■ PARTS LIST

Ref. No.	PART NO.	Description	Remarks	Markets	
*	1	V4126000	SPEAKER CABINET		
	1-1	VU932600	HOLDER		
	1-5	FM177150	ELECTROLYTIC CAP	15uF 50V	
	1-6	VD929600	ELECTROLYTIC CAP	4.7uF 50V	
*	2	V4106400	SPEAKER TERMINAL	203-TST-S14BC	
	2-1	V2729700	EMBLEM	A	
	2-2	VP161000	PUSH NUT	SPN1.5	
*	3	XW307A00	LOUD SPEAKER	TWEETER	
*	4	XW309A00	LOUD SPEAKER	WOOFER	
*	6	V4140500	FRONT GRILLE ASS'Y		
	21	V2769000	HEXAGON SOCET TAPPING SCREW	4x20 MFC2-BL	
	22	EN230180	OVAL HEAD TAPPING SCREW	3.5x16 MFC2-BL	
			ACCESSORIES		
	200	VT704200	SPEAKER CABLE	4.0m	
	201	V4564100	STAND ASS'Y	STANDx1	
*	202	V4564500	LEG	LEGx8	
	203	EP040250	BIND HEAD TAPPING SCREW	4x16 ZMC2-BL	

\* New Parts

## ■ ATTACHING THE STANDS

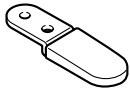

Stand x 8



Screw x 16

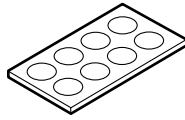

Leg x 8

When placing the speakers, be sure to use the stands to increase stability.

Use the 8 specified holes located on the base of the speaker.

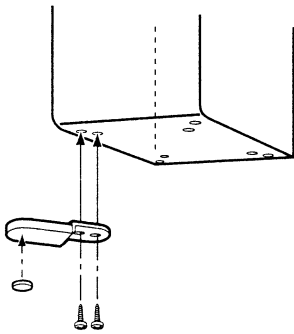

### Procedures

1. Put a screw through the inside hole on the stand and screw it into the speaker at one of the outside holes on the base of the speaker.  
At this time, screw it untightly so that the stand can still be moved.
2. Put another screw through the outside hole on the stand, and screw it into the inside hole on the base of the speaker.
3. Tighten both of the screws firmly.
4. Attach the leg to the bottom of the end portion of the stand.
5. Attach the other stands to the other corners of the base of the speaker in the same way and confirm that all 4 stands have been firmly attached.

### Note

**Be carefull not to apply force to the side of the speaker, otherwise the speaker may fall causing damage to the speaker or personal injury.**